

PASSENGER JUNCTION BOX (PJB) REMOVAL/INSTALLATION

B3E094001072W01

Caution

- When replacing the PJB, the configuration procedure must be performed before removing the PJB. Replacing the PJB without performing the configuration procedure will result in system malfunction.

1. Perform the PJB configuration. (See [PASSENGER JUNCTION BOX \(PJB\) CONFIGURATION.](#))
2. Disconnect the negative battery cable.
3. Remove in the order indicated in the table.

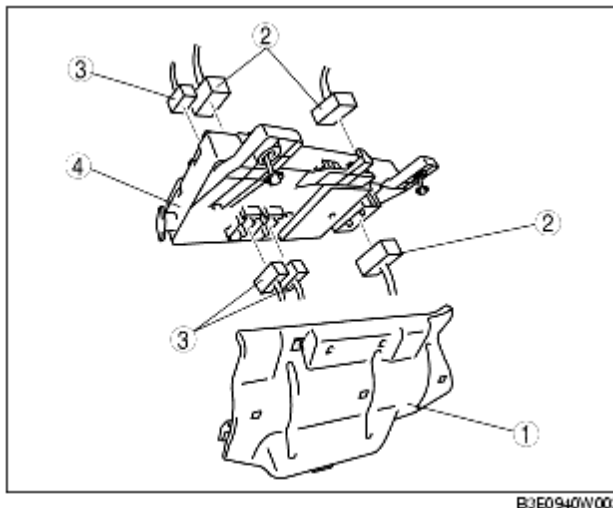

1	Cover
2	Connector A (See Connector A Removal Note.) (See Connector A Installation Note.)
3	Connector B (See Connector B Removal Note.) (See Connector B Installation Note.)
4	PJB (See PJB Removal Note.)

4. Install in the reverse order of removal.

Connector A Removal Note

1. Push the release tab in the direction of the arrow.

2. Rotate the lever in the direction of the arrow and remove connector A.

Connector B Removal Note

1. Rotate the lever in the direction of the arrow and remove connector B.

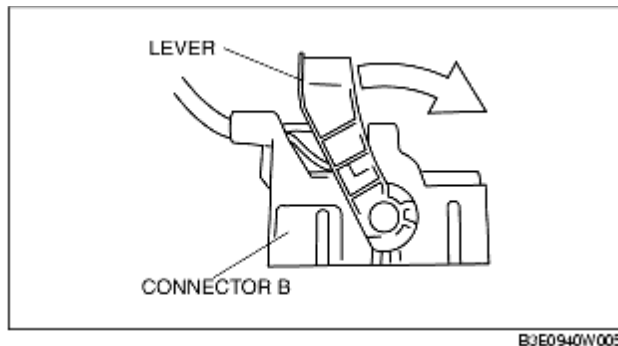

PJB Removal Note

1. Turn the screws counterclockwise to remove the PJB.

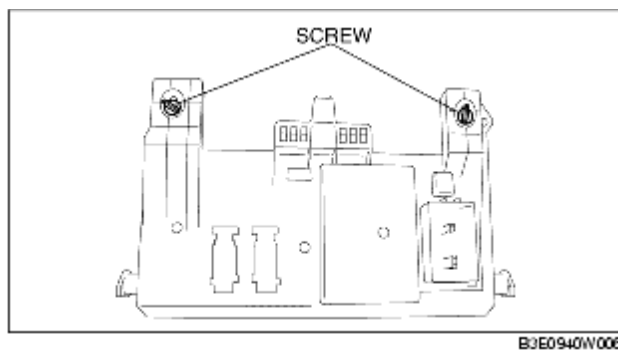

Note

- Screws cannot be removed from the PJB.

2. Remove the PJB as shown in the figure.

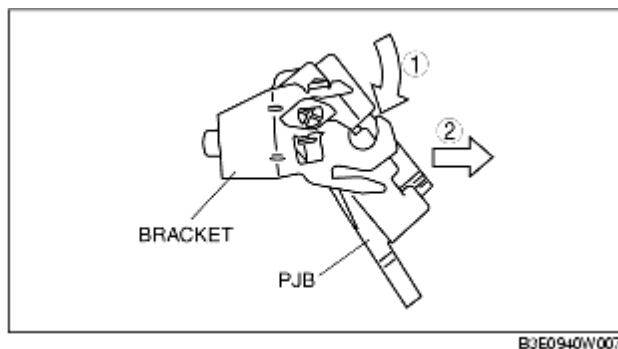

Connector B Installation Note

1. After connecting the connector, rotate the lever in the direction of the arrow to install connector B.

Connector A Installation Note

1. After connecting the connector, rotate the lever in the direction of the arrow to install connector A.

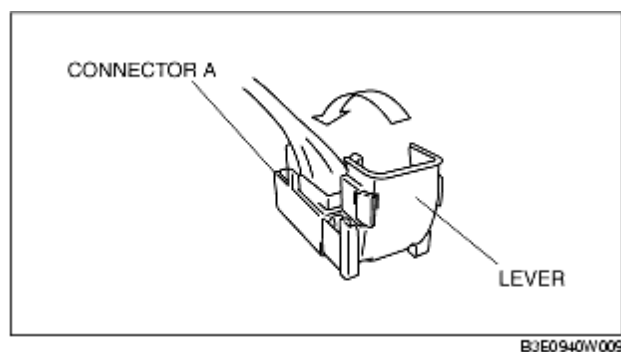

B3E0940W009